

FUEL SYSTEM

PRECAUTION

1. BEFORE WORKING ON FUEL SYSTEM

- (a) Before working on the fuel system, disconnect the cable from the negative battery terminal.
- (b) Do not work on the fuel system near naked flames. Never smoke during the work.
- (c) Keep rubber and leather parts away from gasoline.

2. DISCHARGE FUEL SYSTEM PRESSURE

CAUTION:

- **DISCHARGE FUEL SYSTEM PRESSURE procedures must be performed before disconnecting any part of the fuel system.**
- **As some pressure remains in the fuel line even after taking precautions to prevent gasoline spillage, use a shop rag or piece of cloth to prevent gasoline splashes when disconnecting the fuel line.**

- (a) Disconnect the cable from the negative battery terminal.
- (b) Remove the circuit opening relay (see page [ES-443](#)).
- (c) Connect the cable to the battery negative terminal.
Torque: 3.9 N*m (40 kgf*cm, 35 in.*lbf)
- (d) Start the engine.
- (e) Turn the ignition switch to ON after the engine stops.

HINT:

DTC P0171 (system too lean (Bank 1)) or DTC P0174 (system too lean (Bank 2)) may be set.

- (f) Crank the engine again and check that the engine stops.
- (g) Remove the fuel tank cap and discharge the pressure in the fuel tank completely.
- (h) Install the circuit opening relay (see page [ES-443](#)).

3. FUEL SYSTEM

- (a) When disconnecting the high-pressure fuel line, a large amount of gasoline will splash. So take the following precautions.
 - (1) Discharge the fuel system pressure.
 - (2) Disconnect the fuel tank main tube (see page [FU-42](#)).
 - (3) Drain the fuel remaining in the fuel tank main tube.
 - (4) Cover the disconnected fuel tank main tube (fuel tube joint and fuel tube connector) with a vinyl bag to prevent damage and the intrusion of foreign objects.

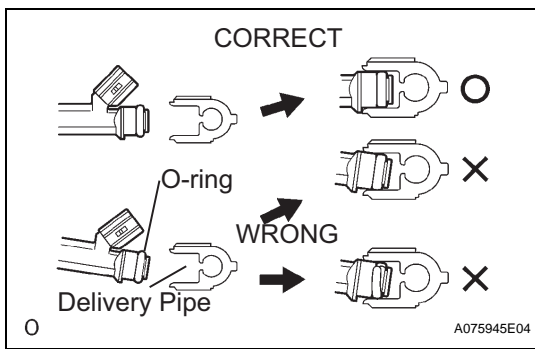

- (b) Take the following precautions when installing the fuel injector.
- (1) Do not reuse the O-ring.
 - (2) Do not damage a new O-ring when installing it into the fuel injector.
 - (3) Before installing a new O-ring, apply gasoline or spindle oil.
- NOTICE:**
Do not use engine oil, gear oil or brake oil.

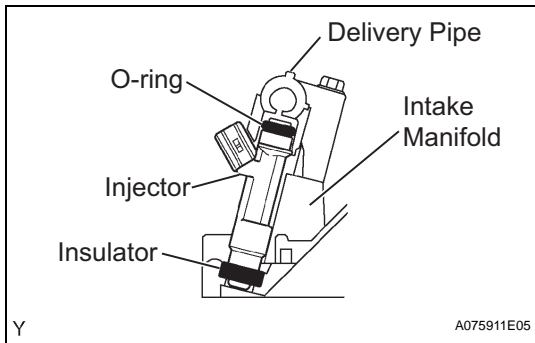

- (4) Install the fuel injector into the fuel delivery pipe and cylinder head as illustrated.
- NOTICE:**
Apply gasoline or spindle oil to the contact surface of the fuel delivery pipe and fuel injector before installing the fuel injector.

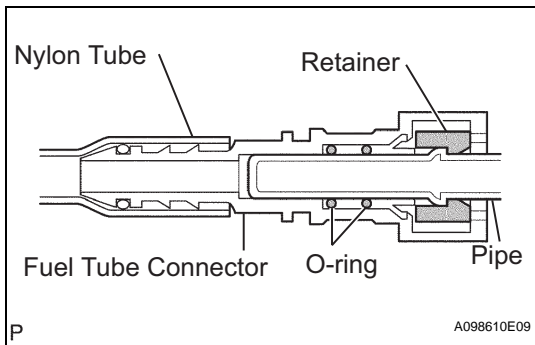

- (c) Take the following precautions when disconnecting the fuel tube connector.
- HINT:**
The structure of the fuel tube connector is as shown in the illustration.
- (1) Check the fuel tube connector and pipe for dirt and mud before removing the fuel tube connector.
If dirty, wipe it with a shop rag or piece of cloth.

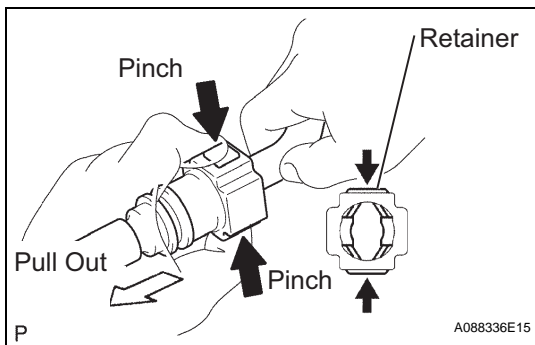

- (2) Pinch the retainer as illustrated, and pull the fuel tube connector out of the pipe.

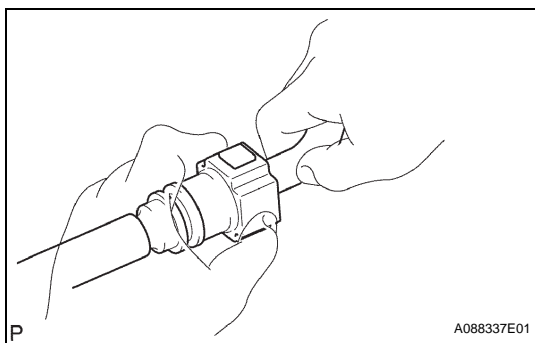

- (3) If the fuel tube connector and pipe are stuck, pinch the pipe, then push and pull the fuel tube connector to release and disconnect it.
- NOTICE:**
Never use any tools.
- (4) After removing the fuel tube, check the sealing surface of the pipe for dirt and mud.
If dirty, wipe it with a shop rag or piece of cloth.
 - (5) Cover the disconnected fuel tube connector and pipe with a vinyl bag to prevent damage and the intrusion of foreign objects.

FU

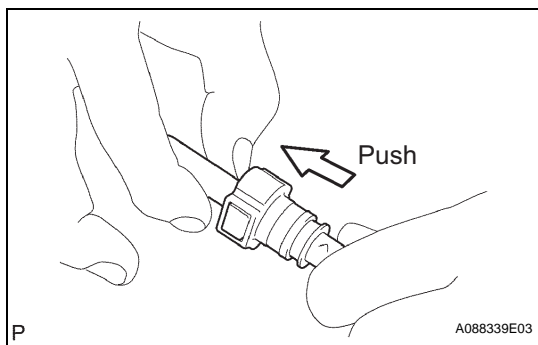

- (d) Take the following precautions when installing the fuel tube connector.
- (1) Align the fuel tube connector with the pipe, then push in the fuel tube connector until the retainer makes a "click" sound.

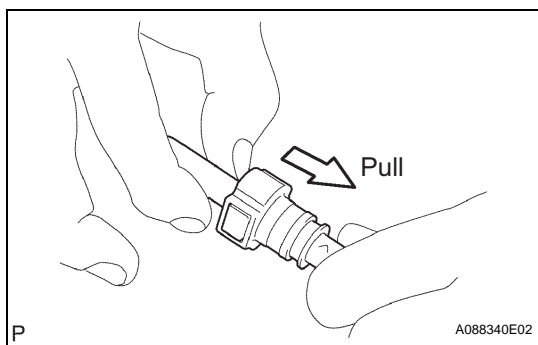

- (2) After connecting the fuel tube connector, check that the fuel tube connector and pipe are securely connected by pulling them.